

CASE STUDY

DATWYLER SUPPORTS INTERMEDIATE PEOPLE'S COURT IN CHENGDU

In its new premises Chengdu Intermediate People's Court has a high-performance Datwyler communications network which considerably boosts the effectiveness of all 24 courts.

Chengdu Intermediate People's Court will shortly be moving to new premises in the south of the city. The new building, with just under 86,000 square metres of floor space, houses 24 courts including the Court of Foreign Affairs and all three authorities for science & technology, administration offices, conference rooms and the local branch of the Sichuan Province Judges College. The move, which is costing 654 million yuan – around 80 million euros – is intended mainly to improve the facilities and working conditions of the city courts, thereby supporting current reform and economic development and ensuring social stability in Chengdu.

The new building, comprising Blocks A, B and C, is located in the heart of the Science & Technology Innovation Center in the southern sub-centre of Chengdu. The buildings give the impression of mountains rising out of the ground and are meant to symbolise the intransigent nature of the law in the face of wrongdoing. At the same time the blocks with their reflective glass façades blend with the nearby park to form a harmonious scene in which "mountains" and "water" mirror each other.

More connections, higher bandwidths

In order to better meet the demands made on employees in their daily work, the solution required for the communications network of the Chengdu Intermediate People's Court was one which provided more connections and higher bandwidths than the previous cabling system.

After several selection rounds the decision was finally made in favour of a high-performance system from Datwyler, a company with an almost 100-year history, whose "Swiss quality" inspires confidence within the Chinese market.

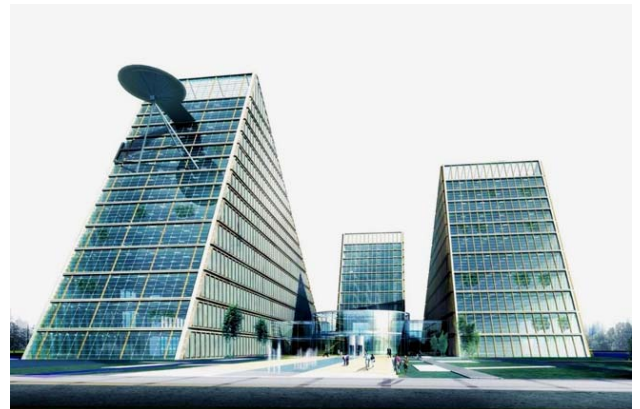

Structured premises cabling

The new network, which was completed in December 2012, covers 12 storeys in both buildings A and B. On the floors it comprises Cat.6 copper data cables, patch panels each with 24 Cat.6 ports and both 25- and 100-pair Cat.3 telephone cables. The backbone is formed from fibre optic cable with OM2 multimode fibres for indoor use and OS2 single-mode fibres for outdoor applications.

The good quality and high bandwidths of the system solution installed, together with all the 4000 connections available to employees, will help bring about a considerable improvement in the working efficiency of Chengdu Intermediate People's Court.

(June 2013)