

CASE STUDY

FUTURE-PROOF CABLING SYSTEM FOR SHANGHAI SEAPORT

High-performance, flexible cabling systems from Datwyler has been installed in the new Yangshan seaport's control centre. This is one of the largest infrastructure projects to be installed in the greater Shanghai area.

To be ready for future needs and upcoming applications, the electrical engineers opted for a Modular Solution from Datwyler. In close cooperation with the customer Datwyler offered a project-specific solution enabling the customer to transmit data, voice and video applications over the same cabling system.

At the beginning of December 2005, the first part of this gigantic seaport was opened. The first five docking places for large freight ships add up to an annual capacity of three million standard containers at six metres length each. At its completion in the year 2020, the Yangshan seaport will offer space for the simultaneous loading and unloading of 50 container ships of the fifth and sixth generation. This will correspond to an annual capacity of 20 million standard containers and will provide Shanghai with the largest container freight port in the world.

The Yangshan seaport is being constructed approximately 30 kilometres offshore from Shanghai near two small islands. The connection to the mainland is provided by a 32 kilometre long bridge with six lanes, which is one of the longest in the world.

The imposing harbour facility is controlled from a futuristic control centre. This was already designed for the full capacity of the port and is equipped with the most modern electronic facilities and a high-performance data network. Special importance was attributed to investment protection due to the long planning horizon of the Yangshan seaport.

Therefore, the electrical engineers decided on a future-proof Class E system solution from Datwyler. The Modular Solution comprises, in addition to very stable Cat. 6 copper data cables, patch panels, patch cords and outlets. Approximately

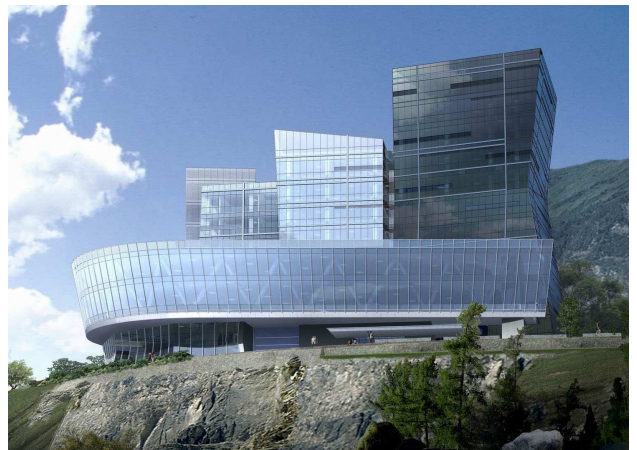

5,000 outlets and over 300 kilometres of data cables ensure that the control centre has the necessary flexibility in all situations and is ready for network extensions in the future.

(February 2006)