

RJ45 plug IP20 Cat. 6_A shielded

for tool-less field assembly



Description

With strain relief.

Field assembly 8-pin RJ45 plug, IP20, Category 6A, shielded, with quick connection technology. The angled position can be chosen from 4 Options

Suitable for cables with the following properties:

Solid copper wire: 0.40 mm up to 0.64 mm, AWG 26/1 up to AWG 22/1

Stranded copper wire: 0.46 mm up to 0.76 mm, AWG 26/7 up to AWG 22/7

Cable sheath diameter: 6 mm up to 8 mm

Protection rating: IP20

Solid housing made of zinc die cast.

Easy on-site assembly without any special tools.

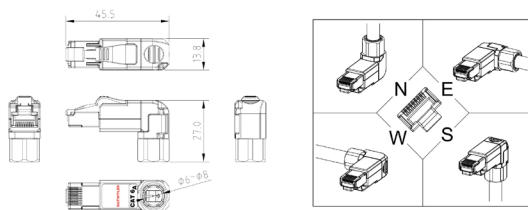

Applicazione

For the transmission of Ethernet protocols in structured premises cabling in the industrial sector.

Standards

Connector standards IEC 60603-7-51

Cabling standards ISO/IEC 11801

Versions

Numero Materiale	Product	Colore	Peso [kg]	Packing unit
418078	RJ45 plug IP20 Category 6 _A , shielded, angled 90°, for field assembly	nera	0,03 kg	1 pc.