

Suspension device LZ 4001

for FH cables

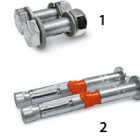

Suspension device LZ 4001

figure 1: Screw set M12x40 for car/counter weight figure 2: Hilti HSL-3 M8/20 for shaft wall

Description

Steel suspension device for a maximum of two Datwyler FH elevator travelling cables.

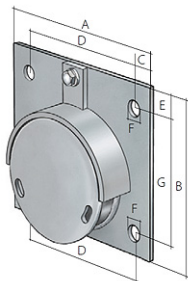

LZ 4001

A = 220 mm
 B = 170 mm
 C = 30 mm
 D = 160 mm
 E = 25 mm
 F = $\varnothing 13$ mm
 G = 120 mm
 thickness of ground plate = 5 mm

Versions

Numero Materiale	Product	Peso [kg]	Packing unit
184606	LZ 4001	2,5 kg	1 pc.
185214	Screw set M12x40 for fixing to elevator car or counter weight	0,14 kg	2 pcs.
185215	Hilti HSL-3 M8/20 for fixing to shaft wall	0,15 kg	2 pcs.

Con riserva di modifiche tecniche

A partire da 2021-01-29 10:23:36