

## Suspension device LZ 4001

for FH cables

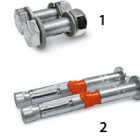

Suspension device LZ 4001

figure 1: Screw set M12x40 for car/counter weight figure 2: Hilti HSL-3 M8/20 for shaft wall

### Description

Steel suspension device for a maximum of two Datwyler FH elevator travelling cables.

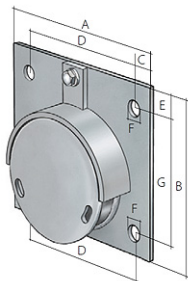

#### LZ 4001

A = 220 mm  
 B = 170 mm  
 C = 30 mm  
 D = 160 mm  
 E = 25 mm  
 F =  $\varnothing 13$  mm  
 G = 120 mm  
 thickness of ground plate = 5 mm

### Versions

Material number	Product	Weight [kg]	Packing unit
184606	LZ 4001	2.5 kg	1 pc.
185214	Screw set M12x40 for fixing to elevator car or counter weight	0.14 kg	2 pcs.
185215	Hilti HSL-3 M8/20 for fixing to shaft wall	0.15 kg	2 pcs.

Subject to technical modification

As of 2021-01-27 11:42:14