

Rail adapter KS IP20

rail mounted

for 1 RJ45 module MS-C6A 1/8 -K



Rail adapter for 1 RJ45 module MS-C6A 1/8 Cat.6A (IEC) 180°-K (Keystone)

Description

IP20 protection rating rail adapter for 1 shielded RJ45 module MS-C6A 1/8 Cat.6A (IEC) 180°-K (Keystone) - can be fitted onto any 35 mm standard (DIN) rail.

The RJ45 module is protected by a cover against direct contact. Protection class II without connection to electrical grounding. When installed as part of a protection class I system, the electrical grounding can be realized by means of an integrated spring via the rail. Its width allows for installations of up to 12 RJ45 modules in a row in any standard electrical distributor.

Suitable for the following Datwyler module:

- RJ45 module MS-C6A 1/8 Cat.6A (IEC) 180°-K (Keystone)

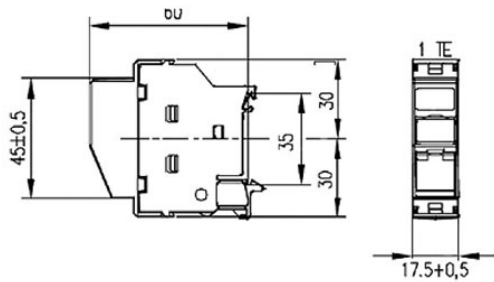

Application

For the transmission of Ethernet protocols in structured premises cabling in the industrial sector.

Versions

Material number	Product	Colour	Weight [kg]	Packing unit
309178	Rail adapter for 1x MS-C6 _A 1/8 -K (Keystone), rail mounted	light grey	0.03 kg	1 pc.